

Düşük Hızlı Yüksek Torklu Hidrolik Motorlar, W11 ve W61 Serileri

Low Speed High Torque Hydraulic Motors, W11-W61 Series



W11 - W61 Serisi Orbit Hidrolik Motorlar / W11-W61 Series Orbit Hydraulic Motor

Oil Distributor	Series	Displacement cc/r [in ³ /r]	Max. Pressure MPa [PSI]	Speed Rpm	Max. Torque Nm [lbf-in]
Spool Valve	W11	50-400 [3.1-24.4]	14 [2030]	145-858	521 [4611]
	W21	50-500 [3.1-30.5]	17 [2465]	110-863	500 [4425]
	W31	100-400 [6.1-24.4]	16 [2320]	121-540	660 [5841]
	W41	245-800 [15.0-48.8]	15 [2175]	106-390	1380 [12214]
Disc Valve	W51	80-500 [4.9-30.5]	28 [4060]	142-856	860 [7612]
	W61	195-985 [11.9-60.1]	31 [4495]	155-865	1877 [16613]

Model Correspondance to Other Brands

WINMAN	Sauer Danfoss	Eaton Charlynn	Parker	M+S	SAM
W11	OMP	H Series	OMP	MP / MLHP	BG, BH
W21	OMR	S Series	TC; TB; TE; TH	MR / MLHR	BR, BS, AR
W31	OMH	--	--	--	--
W41	--	--	TF; TL; TG	MH / MLHH	--
W51	OMS	2000 Series	OMS	MS / MLHS	HR
W61	OMT;OMV	6000 Series	OMT	MT / MLHT; MV / MLHV	HT

Düşük Hızlı Yüksek Torklu Hidrolik Motorlar, W31 Serisi

Low Speed High Torque Hydraulic Motor, W31 Series

W31 Serisi Hidrolik Motor / W31 Series Hydraulic Motor

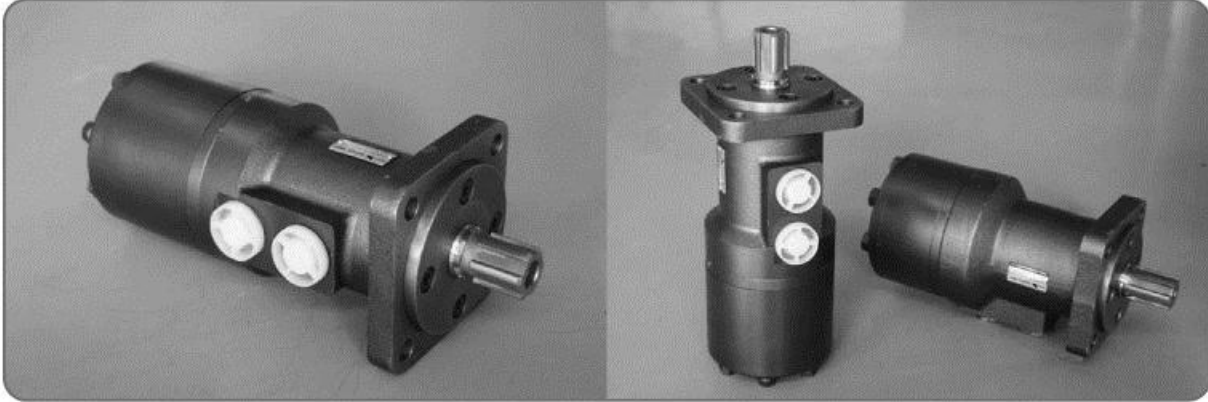

Özellikler / Specifications

Deplasman Displacement cm ³ /r [in ³ /r]		100 [6.1]	160 [9.8]	200 [12.2]	250 [15.3]	315 [19.2]	400 [24.4]
Akış Flow LPM [GPM]	Cont.	50 [11]	50 [11]	50 [11]	50 [11]	50 [11]	50 [11]
	Int.	60 [13]	60 [13]	60 [13]	60 [13]	60 [13]	60 [13]
Max. Hız Max. Speed (RPM)	Cont.	450	281	226	180	147	121
	Int.	540	337	272	216	177	142
Basınç Pressure ^Bar [^ PSI]	Cont.	140 [2030]	125 [1813]	125 [1813]	120 [1740]	120 [1740]	110 [1595]
	Int.	160 [2320]	140 [2030]	140 [2030]	130 [1885]	130 [1885]	125 [1813]
Tork Torque Nm [lbf-in]	Cont.	178 [1575]	272 [2407]	330 [2921]	392 [3469]	499 [4417]	581 [5142]
	Int.	216 [1929]	306 [2708]	357 [3160]	424 [3753]	540 [4779]	660 [5841]

Not:

- Hidromotor aralıklı olarak pik basınçta çıkış de eridir. Hidromotor sürekli belirtilen basınçlarda çalışabilir.
- Motorunda yüksek basınç ve maksimum hız altında çalışma olmamalıdır.
- Çalışma süresi pik basınçta normal sürenin %10'unu geçmemelidir.
- Önerilen hidrolik ya ı, viskozite 37-73 cSt, temizlik ISO18/13 olmalıdır.
- Maksimum çalışma sıcaklığı 80 °C'dir.
- Maksimum çalışma basıncı %40 altında bir saat tam kapasite ile çalışması tavsiye edilir.
- İzin verilen maksimum geri basıncı 100 bar, ancak önerilen geri basınç olmamalıdır. Sızıntı hattına 50 bar kapasiteli boru gerekmektedir.

Note:

- Intermittent means the entrance of the maximum pressure; continuous working pressure means the differential pressure.
- Motor should not work under the highest pressure and the maximum speed.
- The running time should not exceed 10% under intermittent working conditions.
- Recommending N68 anti-wear hydraulic oil, viscosity 37-73cSt, cleanliness ISO18/13.
- The Maximum working temperature is 80°E.
- One hour running time under 40% of maximum working pressure is recommended before full capacity working.
- The maximum allowable back pressure is 10MPa, but the recommended back pressure should not exceed 5MPa.a leaking pipes is needed when exceeding.

Düşük Hızlı Yüksek Torklu Hidrolik Motorlar, W31 Serisi

Low Speed High Torque Hydraulic Motor, W31 Series

Performans Bilgileri

Performance Data

- Sürekli
- Aralıklı
- Continuous
- Intermittent

W31-100 100ml/r

Flow (LPM)	ΔP (Mpa)						
	3	5	7	8	10	12.5	15
8	35	59	83	97	121	147	
	75	74	72	70	69	66	
16	35	60	85	98	125	148	173
	150	147	144	141	138	133	128
22	34	59	84	98	125	147	170
	207	202	198	194	189	183	178
30	33	57	82	95	123	143	168
	282	276	270	267	264	258	248
36	32	55	80	93	120	140	165
	338	331	324	320	317	309	295
45	30	52	78	90	113	136	165
	423	414	405	400	396	387	370
55	25	49	76	88	108	134	162
	517	506	495	489	484	473	456
65		46	75	85	105	132	
		611	598	585	578	572	

W31-160 160ml/r

Flow (LPM)	ΔP (Mpa)						
	3	5	7	8	10	12.5	15
8	56	94	134	155	193		
	47	46	45	44	42		
16	56	95	135	156	195	238	
	94	93	91	90	85	82	
22	55	94	135	155	193	236	278
	138	137	135	134	130	125	120
30	54	93	135	154	193	235	275
	176	175	173	170	166	160	156
36	53	92	133	153	191	232	270
	212	211	210	209	205	200	195
45	52	90	130	150	187	228	265
	264	263	260	259	255	250	243
55	50	86	125	147	180	224	260
	323	322	319	318	313	308	300
65		82	120	141	176	216	212
		382	380	378	370	360	350

W31-200 200ml/r

Flow (LPM)	ΔP (Mpa)						
	3	5	7	8	10	11	12.5
8	70	118	167	193	242	258	
	38	37	35	34	30	26	
16	72	120	170	195	245	260	294
	75	74	72	71	68	66	60
22	71	120	168	193	244	253	292
	103	102	100	99	95	94	88
30	70	118	166	191	242	251	288
	141	140	138	137	134	131	126
36	68	115	162	187	237	248	280
	169	168	166	164	160	156	150
45	65	110	156	182	232	242	276
	212	211	209	208	204	200	196
55		105	152	180	230	238	270
		258	256	255	250	248	242
65		100	145	175	225	231	265
		306	305	302	300	295	290

W31-250 250ml/r

Flow (LPM)	ΔP (Mpa)						
	3	5	7	8	10	11	12.5
8	87	147	208	242	302		
	30	29	28	27	25		
16	88	150	210	245	306	323	362
	60	59	58	57	55	50	48
22	86	150	210	243	304	320	360
	83	82	80	78	75	73	70
30	84	148	208	240	300	315	355
	113	112	110	109	105	103	100
36	80	143	203	235	295	310	351
	135	134	132	131	127	125	120
45	75	140	200	230	290	305	347
	169	168	166	165	160	158	152
55		135	195	225	284	298	340
		206	205	203	200	198	193
65		130	190	220	280	290	340
		244	243	240	238	235	231

W31-315 315ml/r

Flow (LPM)	ΔP (Mpa)					
	3	4	6	8	10	12.5
8	110	148	225	305	380	
	24	23	21	17	13	
16	111	148	227	308	380	450
	48	47	45	42	38	32
22	110	147	226	307	379	448
	66	65	63	61	58	50
30	109	145	222	305	377	444
	90	89	87	85	81	77
36	105	141	219	300	372	440
	107	106	104	102	100	97
45	100	137	215	295	367	433
	134	133	131	128	125	120
55		130	210	290	360	426
		164	162	160	157	153
65			200	285	350	420
			190	189	185	176

W31-400 400ml/r

Flow (LPM)	ΔP (Mpa)					
	3	4	6	8	9	11
8	139	188	286	387	435	
	19	18	17	15	12	
16	139	190	288	390	436	513
	38	37	35	33	32	30
22	138	188	288	390	435	510
	53	52	50	48	47	45
30	137	186	286	388	433	508
	71	70	68	66	64	60
36	135	182	282	385	430	505
	85	84	82	80	78	73
45	130	176	277	380	424	498
	106	105	103	100	98	95
55	123	170	270	372	416	490
	129	128	126	124	123	120
65		160	260	360	402	480
		150	148	146	142	138

Not: Tüm testler hidrolik ya ve 50°C de yapılmıştır. Çalışma şartlarına göre de erler farklılık gösterebilir.
Note: All the data are tested at 50°C with N68 anti-wear hydraulic oil. Actual data may vary slightly from unit to unit in production.

Düşük Hızlı Yüksek Torklu Hidrolik Motorlar, W31 Serisi

Low Speed High Torque Hydraulic Motor, W31 Series

Ölçü ve Montaj Bilgileri / Dimensions and Mounting Data

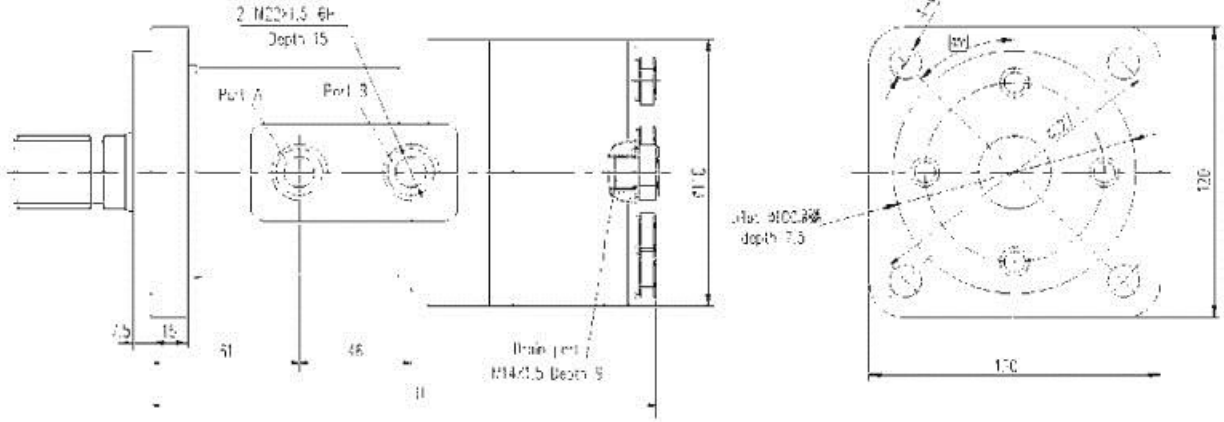

Şaft yük kapasitesi
 Shaft Load Capacity
 Radial Load: 800Kg Max.
 Axis load: 300 Kg max.

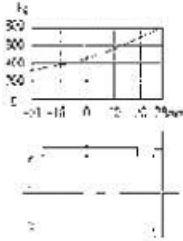

Displacement	100	160	200	250	315	400
H	185	194	200	207.5	217.5	230

Milinin dönme yönü standart şaftın dönüşü motor mili ucu bakarak, "A" portu saat yönünde "B" portu saat yönü tersi
 Direction of shaft rotation standart when facing shaft end of motor, shaft rotation Dockwise when port "A" is pressurized Counter-dockwiseport "B" is pressurized

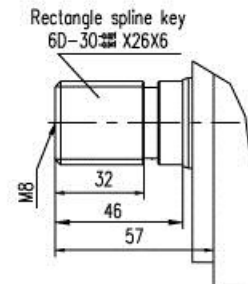
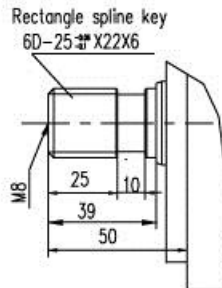
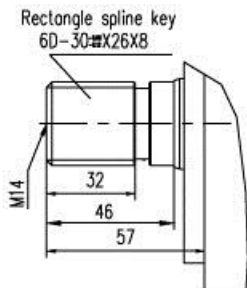
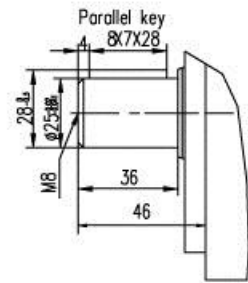
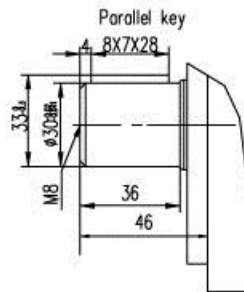
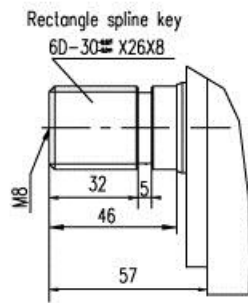

Düşük Hızlı Yüksek Torklu Hidrolik Motorlar, W41 Serisi

Low Speed High Torque Hydraulic Motor, W41 Series

W41 Serisi Hidrolik Motor / W41 Series Hydraulic Motor

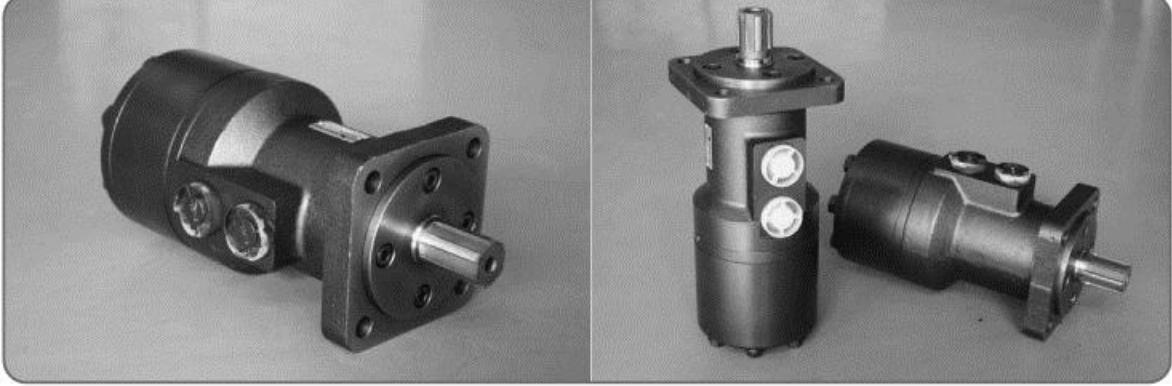

Özellikler / Specifications

Deplasman Displacement cm ³ /r [in ³ /r]		245 [15.0]	310 [18.9]	390 [23.8]	500 [30.5]	630 [38.4]	800 [48.8]
Akış Flow LPM [GPM]	Cont.	80 [18]	80 [18]	80 [18]	80 [18]	80 [18]	80 [18]
	Int.	100 [22]	100 [22]	100 [22]	100 [22]	100 [22]	100 [22]
Max. Hız Max. Speed (RPM)	Cont.	320	250	200	156	120	106
	Int.	390	300	240	200	150	120
Basınç Pressure ^Bar [^ PSI]	Cont.	140 [2030]	140 [2030]	140 [2030]	140 [2030]	125 [1813]	100 [1450]
	Int.	150 [2175]	150 [2175]	150 [2175]	150 [2175]	130 [1885]	120 [1740]
Tork Torque Nm [lbf-in]	Cont.	435 [3850]	556 [4921]	698 [6178]	870 [7700]	997 [8824]	1024 [9063]
	Int.	502 [4443]	664 [5877]	798 [7063]	1058 [9364]	1178 [10426]	1380 [12214]

- Not:**
- Hidromotor aralıklı olarak pik basınçta çıkış de eridir. Hidromotor sürekli belirtilen basınçlarda çalışabilir.
 - Motorda yüksek basınç ve maksimum hız altında çalışma olmamalıdır.
 - Çalışma süresi pik basınçta normal sürenin %10'unu geçmemelidir.
 - Önerilen hidrolik ya ı, viskozite 37-73 cSt, temizlik ISO18/13 olmalıdır.
 - Maksimum çalışma sıcaklığı 80 °C'dir.
 - Maksimum çalışma basıncı %40 altında bir saat tam kapasite ile çalışması tavsiye edilir.
 - İzin verilen maksimum geri basıncı 100 bar, ancak önerilen geri basınç olmamalıdır. Sızıntı hattına 50 bar kapasiteli boru gerekmektedir.

- Note:**
- Intermittent means the entrance of the maximum pressure; continuous working pressure means the differential pressure.
 - Motor should not work under the highest pressure and the maximum speed.
 - The running time should not exceed 10% under intermittent working conditions.
 - Recommending N68 anti-wear hydraulic oil, viscosity 37-73cSt, cleanliness ISO18/13.
 - The Maximum working temperature is 80°E.
 - One hour running time under 40% of maximum working pressure is recommended before full capacity working.
 - The maximum allowable back pressure is 10MPa, but the recommended back pressure should not exceed 5MPa. a leaking pipes is needed when exceeding.

Düşük Hızlı Yüksek Torklu Hidrolik Motorlar, W31 Serisi

Low Speed High Torque Hydraulic Motor, W31 Series

Opsiyonel Ölçüler Kod Numaraları / Code Numbers for Optional Dimensions

Parameters			Discharges						
Flange	Shaft	Oil Port	100	160	200	250	315	400	
Bolt hole: 4- ϕ 13 ; pilot: ϕ 100	6D-30X26X6	M22X1.5, without drain port	31 - 10 10	-101 1	-101 2	-101 3	-101 4	-101 5	
	6D-30X26X8	M22X1.5, without drain port	31 - 10 20	-102 1	-102 2	-102 3	-102 4	-102 5	
	6D-30X26X6	M22X1.5, Drain port M14X1.5,	31 - 10 30	-103 1	-103 2	-103 3	-103 4	-103 5	
	6D-30X26X8	M22X1.5, Drain port M14X1.5,	31 - 10 40	-104 1	-104 2	-104 3	-104 4	-104 5	
	Straight 25,key 8	shaft width	M22X1.5, Drain port M14X1.5,	31 - 00 50	-005 1	-005 2	-005 3	-005 4	-005 5
	Straight 25,key 8	shaft width	M22X1.5, without drain port	31 - 00 60	-006 1	-006 2	-006 3	-006 4	-006 5
	Straight 30,key 8	shaft width	M22X1.5, Drain port M14X1.5,	31 - 00 70	-007 1	-007 2	-007 3	-007 4	-007 5
	Straight 30,key 8	shaft width	M22X1.5, without drain port	31 - 00 80	-008 1	-008 2	-008 3	-008 4	-008 5
	6D-30X26X8(Center hole threadM14)		M22X1.5, without drain port	31 - 10 90	-109 1	-109 2	-109 3	-109 4	-109 5